

K3VL80/112/140

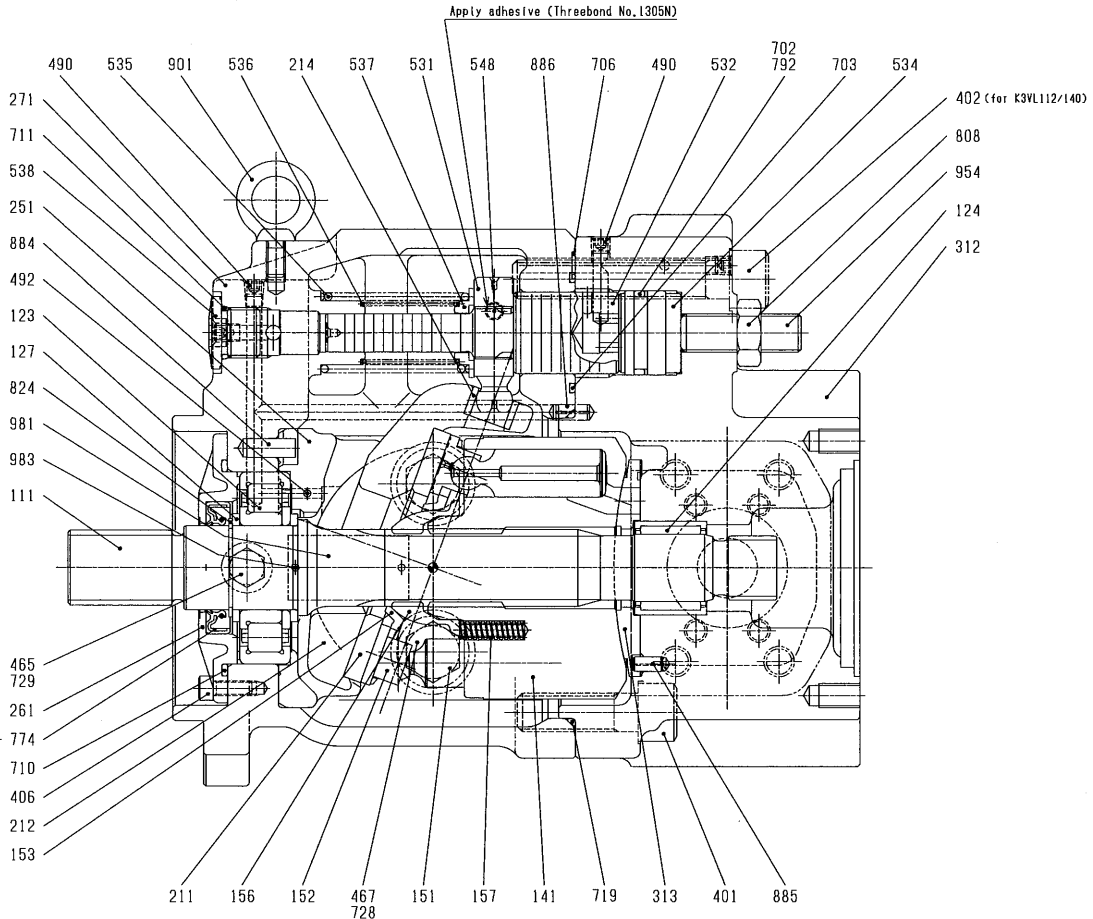

Apply lubricant (NOK SEALUB L101) to the oil seal circumferential surface

TIGHTENING TORQUE FOR K3VL80

NO.	NOMINAL DESIGNATION OF SCREW THREAD	TIGHTENING TORQUE N·m
401	M16	240
406	M6	12
465	7/16-20UNF	12
	M14x1.5	25
467	3/4-16UNF	98
	M22x1.5	98
490	NPTF1/16	11
531, 532	M22x1.5	240
538	G 1/2	110
808	M16	130

TIGHTENING TORQUE FOR K3VL112/140

NO.	NOMINAL DESIGNATION OF SCREW THREAD	TIGHTENING TORQUE N·m
401, 402	M20	430
406	M8	30
465	7/16-20UNF	12
	M14x1.5	25
467	1-1/16-12UN	170
	M27x2.0	170
490	NPTF1/16	11
531, 532	M27x1.5	240
538	G 3/4	240
808	M20	240

SUPPLY CLASSIFICATION

B	PARTS SUPPLIED SUB-ASSEMBLED
/	CONSTITUENTS OF B (NOT INDIVIDUALLY SUPPLIED)
C	PARTS INDIVIDUALLY SUPPLIED
D	STANDARDIZED PARTS COMMONLY AVAILABLE

B	530	ASS'Y, tilting pin	1ST	531 (1PC), 548 (1PC)
B	030	ASS'Y, swash plate	1ST	212 (1PC), 214 (1PC)
B	013	ASS'Y, cylinder	1ST	141 (1PC), 313 (1PC)
B	011	ASS'Y, piston	1ST	151 (9PC), 152 (9PC)
CLASS.	NO.	PART NAME	Q'TY	CONSTITUENT PART NO. (Q'TY)

CLASS.	No.	PART NAME	MATERIAL	Q'TY
C	983	PIN	COPPER ALLOY	2
C	981	PLATE, name	Al ALLOY	1
C	954	SCREW, set	ALLOY STEEL	1
D	901	BOLT, eye	CARBON STEEL	1
D	886	PIN, spring	TOOL STEEL	1
C	885	PIN, valve plate	BEARING STEEL	1
C	884	PIN	BEARING STEEL	1
D	824	RING, snap	TOOL STEEL	1
D	808	NUT	CARBON STEEL	1
D	792	RING, back-up	SYNTHETIC RESIN	1
C	774	SEAL, oil	FLUORO RUBBER	1
D	729	O-RING	NBR	1
D	728	O-RING	NBR	2
D	719	O-RING	NBR	1
D	711	O-RING	NBR	1
D	710	O-RING	NBR	1
C	706	SQUARE-RING	FLUORO RUBBER	3
C	703	O-RING	FLUORO RUBBER	1
C	702	O-RING	FLUORO RUBBER	1
/	548	PIN, feed back	BEARING STEEL	1
C	538	PLUG	CARBON STEEL	1
C	537	SEAT, spring	CARBON STEEL	1
C	536	SPRING, inner	SPRING STEEL	1
C	535	SPRING, outer	SPRING STEEL	1
C	534	STOPPER (L)	ALLOY STEEL	1
C	532	PISTON, servo	ALLOY STEEL	1
/	531	PIN, tilting	ALLOY STEEL	1
C	492	KOENIG PLUG	Al ALLOY	1
C	490	PLUG	CARBON STEEL	6
C	467	PLUG	CARBON STEEL	2
C	465	PLUG	CARBON STEEL	1
D	406	SCREW, hex, S.H.C.	ALLOY STEEL	4
D	402	SCREW, hex, S.H.C.	ALLOY STEEL	1
D	401	SCREW, hex, S.H.C.	ALLOY STEEL	4
/	313	PLATE, valve	COPPER ALLOY / ALLOY STEEL	1
C	312	COVER, valve	DUCTILE	1
C	271	CASING, pump	CAST IRON	1
C	251	COVER, seal	Al ALLOY	1
C	251	SUPPORT, S.P.	CAST IRON	1
/	214	BUSH, fitting	BEARING STEEL	1
/	212	PLATE, swash	DUCTILE	1
C	211	PLATE, shoe	BEARING STEEL	1
C	157	SPRING, cylinder	SPRING STEEL	9
C	156	BUSH, spherical	CAST IRON	1
C	153	PLATE, set	ALLOY STEEL	1
/	152	SHOE	COPPER ALLOY	9
/	151	PISTON	ALLOY STEEL	9
/	141	BLOCK, cylinder	DUCTILE	1
C	127	SPACER, bearing	CARBON STEEL	2
C	124	BEARING, needle	BEARING STEEL	1
C	123	BEARING, roller	BEARING STEEL	1
C	111	SHAFT, drive	ALLOY STEEL	1

SERIAL NO. \_\_\_\_\_ DATE \_\_\_\_\_  
 MADE IN \_\_\_\_\_  
 SCALE 1/1  
 DATE Nov. 04, 2013  
 DRAWN T. Horie/T. Tanaka  
 CHECKED \_\_\_\_\_  
 PART NO. K3VL80/112/140  
 CROSS SECTION  
 02416-8888  
 PRECISION MACHINERY COMPANY